

Rotary Cam Switches

Enclosed Switches with insulated enclosure 125 × 100 × 133 mm

Enclosed Switches with insulated enclosure 125 × 100 × 133 mm

- with cover interlock, interlocked in ON position
- 20 A / 25 A / 32 A ■ 1 up to max. 12 contacts
- IP66
- Insulated polycarbonate enclosure

- Main/Emergency-Off Switch
- Main Switch



Setup of order code number: Type - Switching programme - Mounting form Ordering example: 6 pole ON-OFF Switch 90°, 20 A, padlock device with N-handle yellow/red →	Type	Switching programme	Mtg. form
	M220	61907	275N4
	Order code no. M220-61907-275N4		

Type	Contacts	Rated data (IEC 60947)			Degree of Protection	Terminal accessibility
		Operational current I _e AC-21A (A)	Operational power (at 380–440 V)			
			AC-23A (kW)	AC-3A (kW)		
P220	1 to 10	20	7.5	5.5	IP66	Terminals accessible from mounting direction
P225	1 to 8	25	11	7.5	IP66	
M220	1 to 12	20	7.5	5.5	IP66	Terminals accessible laterally
M225	1 to 10	25	11	7.5	IP66	
T225	1 to 8	32	15	11	IP66	Terminals accessible laterally

Switching programme	Stages	Contacts	Description
61919 for types P220/P225	4	8	ON-OFF Switch 90°, 8 pole, 2 pole early make/late break
61918 for types P220/P225	4	8	ON-OFF Switch 90°, 8 pole
61910 for type P220	5	10	ON-OFF Switch 90°, 10 pole
61907 for types M220/M225/T225	4	8	ON-OFF Switch 90°, 6 pole, 2 auxiliary contacts
61910 for types M220/M225	5	10	ON-OFF Switch 90°, 10 pole

Switching diagrams and further switching programmes from page 56.

Mounting form	Operator	Main/Emergency-Off Switch	Mounting form	Operator	Main Switch
275N4		padlock device with N-handle yellow/red	275N1		padlock device with N-handle black
275M4		padlock device with M-handle yellow/red	275M1		padlock device with M-handle black
275V4		padlockable with V-handle yellow/red	275V1		padlockable with V-handle silver/black

Dimensions in mm:

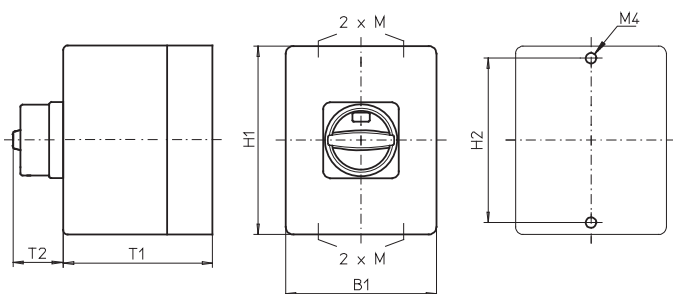

Mounting form	H1	B1	T1	T2	2 × M	H2
275N4/275N1	125	100	133	33	20/25	115
275M4/275M1	125	100	133	38	20/25	115
275V4/275V1	125	100	133	32	20/25	115

Rotary Cam Switches

Technical Information Switching programmes

ON-OFF Switches 90°

Description	Stages	Contacts	Ident No.	Ident No. with inscription
1 pole	1	1	61191.	
2 pole	1	2	61192.	
3 pole	2	3	61199.	
3 pole with N/PE terminals	2	4	61178.	
3 pole with N terminals	2	4	61908.	
4 pole	2	4	61914.	
4 pole, 1 pole early make/late break	2	4	61194.	
4 pole, 3 pole early make/late break	2	4	61904.	
5 pole, 3 pole early make/late break	3	5	61905.	
6 pole	3	6	61906.	
6 pole, 2 auxiliary contacts	4	8	61907.	61...F 61...H 61...K
7 pole	4	7	61917.	
8 pole	4	8	61918.	
8 pole, 2 pole early make/late break	4	8	61919.	
9 pole	5	9	61909.	
10 pole	5	10	61910.	
12 pole	6	12	61912.	
Complete rotation				
2 pole	1	2	61198.	
3 pole	2	3	61197.	

ON-OFF Switches 60°

Description	Stages	Contacts	Ident No.	Ident No. with inscription
1 pole	1	1	61001.	
2 pole	1	2	61002.	
3 pole	2	3	61003.	
4 pole	2	4	61004.	
5 pole	3	5	61005.	
6 pole	3	6	61006.	
7 pole	4	7	61007.	
8 pole	4	8	61008.	
9 pole	5	9	61009.	
10 pole	5	10	61010.	
11 pole	6	11	61011.	
12 pole	6	12	61012.	

ON-OFF Switches with spring return

Description	Stages	Contacts	Ident No.	Ident No. with inscription
Spring return to OFF				
1 pole	1	1	61351.	
2 pole	1	2	61352.	
3 pole	2	3	61353.	
4 pole	2	4	61354.	61...- 61...A
Spring return to ON				
1 pole	1	1	61302.	
				61302- 61302A

Changeover Switches with centre OFF, 60°

Description	Stages	Contacts	Ident No.	Ident No. with inscription
1 pole	1	2	61025.	
2 pole	2	4	61026.	
3 pole	3	6	61027.	
4 pole	4	8	61028.	
5 pole	5	10	61029.	
6 pole	6	12	61030.	
7 pole	7	14	61031.	
8 pole	8	16	61032.	
without jumpers				
1 pole	1	2	61625.	
2 pole	2	4	61626.	
3 pole	3	6	61627.	
				61...A
				61...B
				61...C
				61...D
				61...E
				61...G
				61...H
				61...I
				61...J
				61...K
				61...L
				61...M
				61...N
				61...O
				61...P
				61...Q
				61...R
				61...S
				61...T
				61...U
				61...V
				61...W

Changeover Switches with centre OFF, 90°

Description	Stages	Contacts	Ident No.	Ident No. with inscription
1 pole	1	2	61151.	
2 pole	2	4	61152.	
3 pole	3	6	61153.	
4 pole	4	8	61154.	
				61...A
				61...B
				61...C
				61...D
				61...E

Changeover Switches with centre OFF and spring return

Description	Stages	Contacts	Ident No.	Ident No. with inscription
Spring return to centre				
1 pole	1	2	61361.	
2 pole	2	4	61362.	
3 pole	3	6	61363.	
without jumpers				
1 pole	1	2	61761.	
2 pole	2	4	61762.	
				61...A
				61...B
				61...C
				61...D
				61...E
				61...F
				61...G
				61...H
				61...I
				61...J
				61...K
				61...L
				61...M
				61...N
				61...P
				61...Q
				61...R
				61...S
				61...T